

器械室

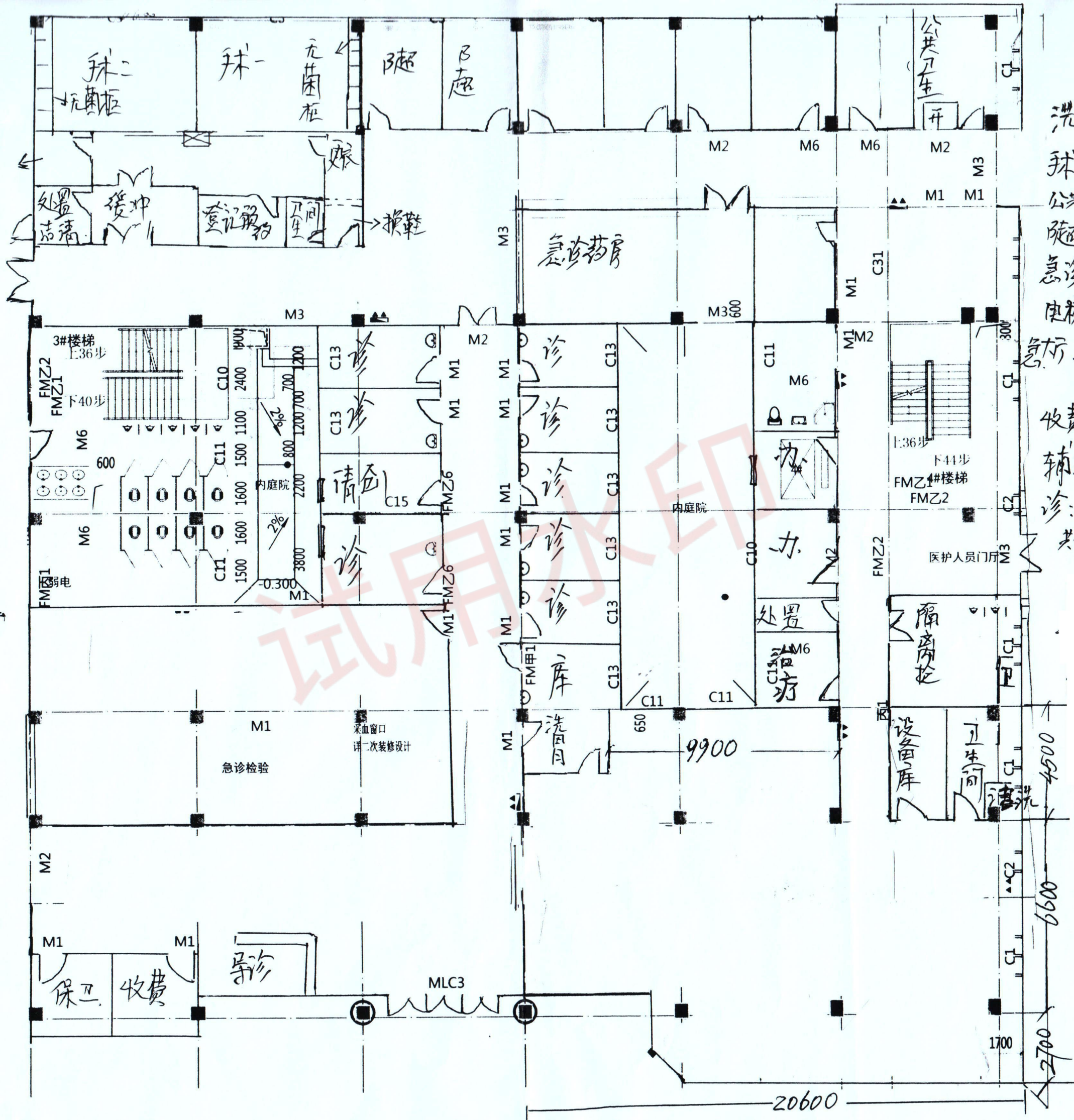

洗胃 $2.5 \times 3 = 7.5m^2$

球: $13.2 \times 9 = 118.8m^2$

公共厕所: $22.68m^2$

院前急救: $118.8m^2$

急诊药房: $44.55m^2$

电梯及前厅 $7.4 \times 3.3 = 24.42m^2 \times 2 = 48.84m^2$

急诊 (13.8 x 20.7) + 4.5 x 10.8 (3 x 4) - 6.6 x 3.5 = 374.46m^2

收费: $11.22m^2$

辅助: $72m^2$

诊: $10 \times 3.3 \times 4.5 = 148.5m^2$

共计: $1044.2m^2$